

My Visit to Boston Children's Museum



I am going to
BOSTON
CHILDREN'S
MUSEUM today.

When I see the Hood Milk Bottle
I will know I am there!





My family and I will **EXPLORE** the Museum, **LEARN** new things, and have **FUN**.

When I get to the Museum,
I will wait in **LINE**. I will wait
patiently for my turn.

Then Museum Staff or my
parent will put a **STAMP** on my
HAND. I will feel the stamp
press on my hand, and it will
not hurt.





The Museum Staff wear **GREEN** shirts or aprons and have a **NAME BADGE**.

I show my **HAND STAMP** to the Museum Staff when entering the Museum.

MUSEUM STAFF are adults I can learn from at Boston Children's Museum, and they can answer my questions or help me if I get lost.

My **FAMILY** and I will decide what to see at the Museum. I can let my family know what I would like to see.

I will not have time to see everything.

I will try to **COOPERATE** with my family and that way we will have fun.

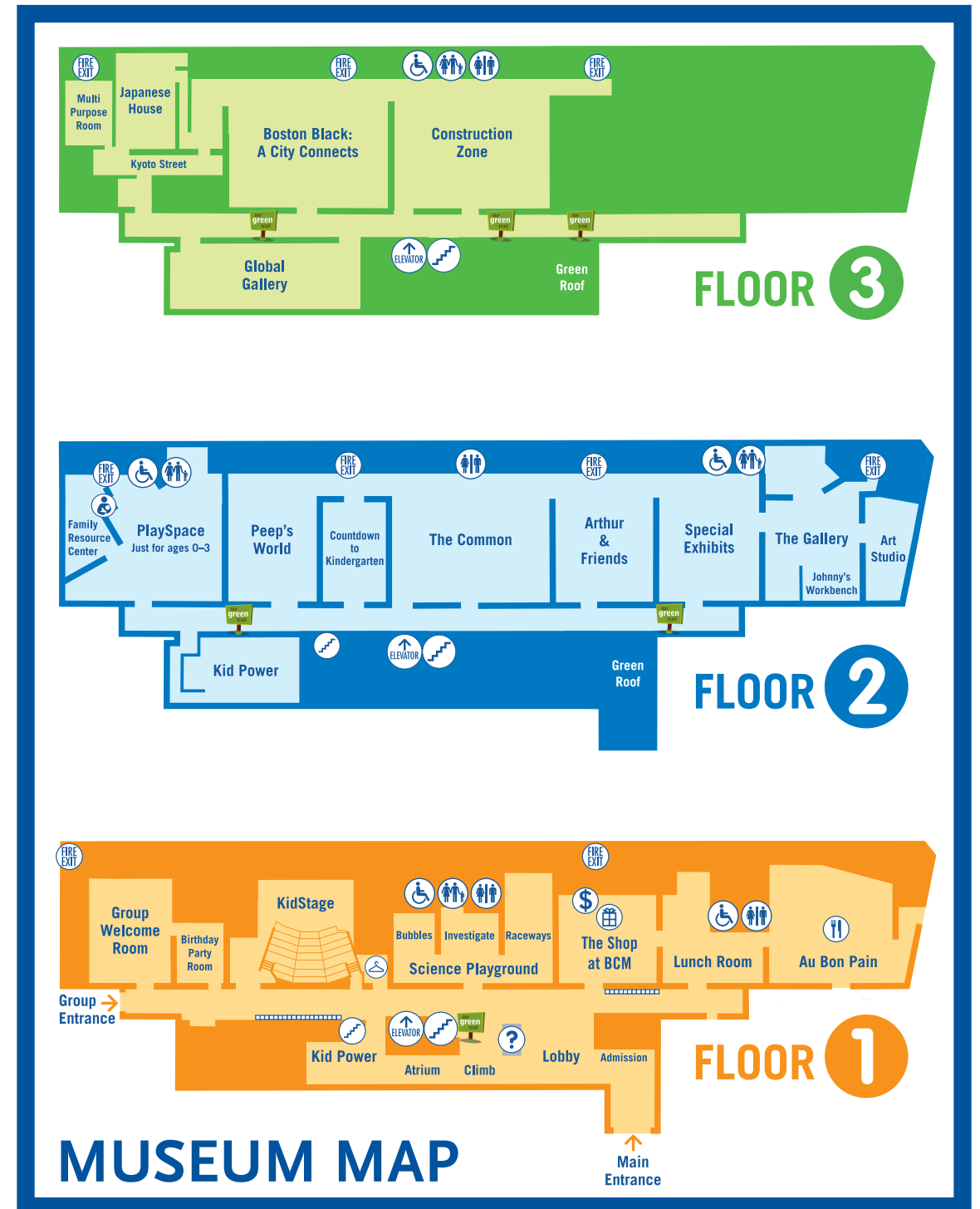



One exhibit we might visit is **SCIENCE PLAYGROUND.**

In this room there will be many science activities. I can blow **BUBBLES**, put golf balls onto a **TRACK**, and can explore many **OBJECTS** at a table.

I may need to take turns with other Museum visitors. This space can be exciting and loud, and I will try to stay calm.

Another exhibit we might visit is **THE CLIMB.**

This is a big climbing structure in the middle of the Museum. I will **CRAWL** up on my hands and knees, and when I get to the top I have to **CLIMB** back down to get out.

My family will watch me and help me if I feel scared. I may have to wait for other Museum visitors and be patient when inside *The Climb*.





Another exhibit my family might visit is **COUNTDOWN TO KINDERGARTEN.**

This exhibit looks like a school **CLASSROOM.** I can sit at a table with math, science, or writing activities. I can find the library corner and read books, or I can listen to books with headphones.

Another exhibit we might visit is
PEEP'S WORLD.

In this exhibit I can play with water or see my shadow. I may get **WET** in this exhibit, but I can put on a **SMOCK** to stay dry.

The room may smell different because of the water, and there is **MUSIC** I will hear. I will keep my body calm and have fun exploring in *Peep's World*.





Another exhibit we might visit is **CONSTRUCTION ZONE**.

In *Construction Zone* I will have many choices. I can play with **BLOCKS** and **TRUCKS**. I can sit in the Bobcat®. I can crawl into dark **TUNNELS** or I can climb up structures.

I might have to wait my turn to play. I will hear loud sounds and will see **BLINKING, YELLOW LIGHTS**. I will try to stay calm if I get too excited.

If the Museum gets too loud, my family and I can find a **QUIET SPACE** on the third floor bridge to sit and take a break.

In the quiet space I can look out the **WINDOWS** at the **WATER**, and I can take slow, deep breaths until I am ready to explore more.





When visiting exhibits in the Museum, I can take the **STAIRS** or the **ELEVATOR**. If I take the elevator, I may have to wait and it may be crowded inside.

The elevator has a big window and I can see outside when going up and down. I can also look at the **NUMBER BUTTONS** in the elevator.

My family and I may visit the **THE SHOP AT BCM** and the **LUNCH ROOM**. In The Shop at BCM, there are lots of toys to see, and I can look at the toys. The toys are for Museum visitors to buy.



It may be crowded in the store, so I will stay close to my family. In the Lunch Room, there are many tables and chairs. This is the only place inside the Museum where I can **EAT** food or have a **DRINK** with my family. I can find a bathroom in the lunchroom, too.





At the end of the visit, I will leave the Museum and wave good-bye to the Hood Milk Bottle. I had a great day at

**BOSTON
CHILDREN'S
MUSEUM!**

NOTES



Developed in collaboration with Boston University Department of Occupational Therapy. With special contribution by Allison Boris, M.A.

This project was made possible by a grant from the US Institute of Museum and Library Services.

Photography by Julia Geller, Clive Grainger, and Karin Hansen

The End.



**BOSTON
CHILDREN'S
MUSEUM**

308 Congress Street
Boston, MA 02210
www.BostonChildrensMuseum.org